

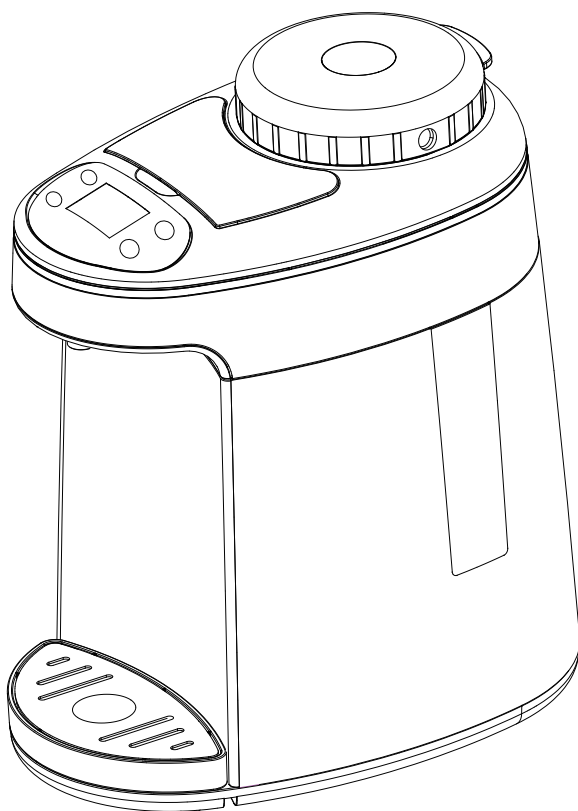

HYDROGEN WATER POT INSTRUCTION MANUAL

EOS7150-H / EOS7150-HG



Thank you for purchasing this Biolux product.

Please read the instructions carefully and follow the safety precautions when using this product. Before using this product please pay special attention to the "IMPORTANT SAFEGUARDS" (P. 2~4). This product is intended for household use only.

Table of Contents

1	Important Safeguards	P.02
2	Main Features	P.05
3	Specifications	P.06
4	Parts and Handling Instructions	P.07
5	Preparation before Using	P.09
6	How to Use	P.13
	Hydrogen Water Production	P.13
	Heating Function	P.15
	Dispensing Hydrogen Water	P.18
	How to Dispose Water	P.19
	How to Connect Cannula (Hydrogen Inhalation)	P.20
	*EOS7150-HG exclusive	
	Gas Delivery (Hydrogen Inhalation)	P.21
	*EOS7150-HG exclusive	
7	System Menu & Settings	P.22
	LED Effect	P.22
	Info / Setting	P.23
8	Cleaning & Maintenance	P.24
9	Troubleshooting	P.26
10	Q&A on Product Use	P.28

The illustrations used in this Instruction Manual may vary from the actual product that you have purchased.

1 IMPORTANT SAFEGUARDS

Basic safety precautions should always be followed when using electrical appliances, including the following:

1. Read all instructions thoroughly.
2. Avoid touching hot surfaces and do not block or clog the gas vent opening under any circumstances.
3. To safeguard against fire, electric shock and possible injury, keep the power cord, plug and the appliance away from water or other liquids.
 - *Do not pour water directly from the tap.*
 - *Do not put the unit in a sink or allow it to get wet.*
 - *Do not turn the unit upside down when the bottom is wet.*
4. Close supervision is recommended when the appliance is used by or near children.
 - *Do not allow children or any person unfamiliar with the appliance to use it.*
 - *Do not leave the unit within the reach of infants.*
 - *Special attention must be given to prevent infants from putting the plug into their mouth.*
5. Unplug from outlet when not in use and before cleaning. Allow to cool before adding or removing parts, and before cleaning the appliance.
 - *When unplugging, pull by the power plug, not the cord.*
 - *Do not touch the hot surfaces, especially the heating surface of the product.*
6. Do not use or operate the unit with a damaged cord or plug. If the appliance malfunctions or has been damaged in any manner, unplug the appliance and return it to the nearest authorized service facility for examination, repair or adjustment.
 - *Never disassemble, repair, or modify the unit.*
 - *If the power supply cord is damaged, it must be replaced by the manufacturer or its authorized service agent.*
7. Do not use the Power Cord bundled up. Doing so may cause the Power Cord to become excessively hot, resulting in malfunction.
8. The use of accessories or attachments not recommended by the appliance manufacturer may result in electric shock or other injury to persons.
9. Do not use outdoors. Do not place on a unstable surface or near any subjects that can be affected by heat.
10. Keep the power cord away from hot surfaces and do not let the cord hang over the edge of tables or counters.
11. Do not place on or near a heated surface such as a gas or electric stove, or in a heated oven.
12. Always use extreme caution when moving an appliance containing hot liquids.
13. Use a single outlet that matches the power rating of the appliance.
14. Do not use the appliance for other than intended or specified purposes.
15. To protect against electrical hazard, unplug the cord before cleaning.
16. Scalding may occur if the lid is removed during heating.

SAVE THIESE INSTRUCTIONS

THIS APPLIANCE IS FOR HOUSEHOLD USE ONLY.

- A. A short power-supply cord has been provided for your safety. To reduce risks from entanglement or tripping, a longer cord is not recommended.
 - B. Extension cords should only be used if care is exercised.
 - C. If using a extension cord: (1) the marked electrical rating of the extension cord should be at least as high as the electrical rating of the appliance; (2) if the appliance is of the grounded type, the extension cord should have a ground-type 3-pronged plug; and (3) the longer cord should not drape over the countertop or tabletop where it can be pulled on by children or tripped over.
-

Before Use

These WARNINGS and CAUTIONS are intended to protect you and others from personal injury and household damage. To ensure safe operation, please follow carefully.



WARNINGS

This product generates hydrogen gas. While normal use of this product would not create an explosion hazard, care must always be taken when using hydrogen. Failure to operate this product in accordance with instructions set forth in this manual may create a hazardous situation.

- *Standard precautions for the use of hydrogen should be taken when using the product.*
- *Do not use any form of gas storage vessel in conjunction with the product to store hydrogen. Stored quantities of hydrogen pose an explosion hazard.*
- *Do not use any open flame or other ignition source within 25cm (10 inches) of the Lid or Lid Vent.*

Do not modify the product. Only a repair technician may disassemble or repair this unit.

- *Attempting to do so may cause fire, electric shock or injury. Make any repair inquiries to our Customer Service.*

Do not immerse the product in water or splash it with water, and do not put it on a wet surface such as a sink.

- *Doing so may cause short circuit or electric shock.*

Do not plug or unplug the Power Cord if your hands are wet.

- *Doing so may cause electric shock or injury.*

Do not allow children to use the product unsupervised. Keep it out of the reach of infants.

- *Children are at risk of fire, burns, electric shock or injury.*

Do not tilt the product or tip it over.

- *Hot water may spill from the Spout or Gas Vent, even if the Dispense Lock is on.*

Insert the Power Plug completely and securely into the electrical outlet.

- *A loosely inserted Power Plug may cause electric shock, short circuit, smoke or fire.*

Do not damage the Power Cord. Do not bend, pull, twist, fold, or attempt to modify the Power Cord. Do not place it on or near high temperature surfaces or appliances, under heavy items or between objects.

- *A damaged Power Cord can cause fire or electric shock.*

Do not use the product if the Power Plug or Power Cord is damaged or if the Power Plug is loosely inserted into the electrical outlet.

- *Doing so may cause electric shock, short circuit or fire.*

Use only an electrical outlet rated at 15 amperes minimum, and do not plug other device into the same outlet.

- *Plugging other devices into the same outlet may cause the electrical outlet to overheat, resulting in fire.*

If the blades or surface of the Power Plug become soiled, wipe them clean.

- *A dirty Power Plug may cause fire.*

Do not use a power supply voltage other than being specified on the product.

- *Use of any other power supply voltage may cause fire or electric shock.*

Do not place ice inside of the product.

- *Doing so may cause condensation, resulting in electric shock or breakdown of the product.*

Stop using immediately if you notice any of the following symptoms indicating a malfunction or breakdown.

- *The Power Plug or Power Cord has become very hot.*
- *The Power Cord is damaged or the electricity turns on and off when touched.*
- *The Body is deformed or unusually hot.*
- *Smoke is arising from the product or there is burning smell.*
- *Some part of the product is cracked, loose or unstable.*
- *The product heats water continuously and does not turn to Keep Warm mode.*

If any of the above occurs, unplug the product immediately and return to the store where you purchased it for check-ups and/or repairs. Continued use of the product may cause smoke, fire, electric shocks or injury.



CAUTIONS

This product is not intended for use by persons (including children) with reduced physical, sensory or mental capabilities, or lack of experience and knowledge, unless they have been given supervision or instruction concerning use of the product by a person responsible for their safety. Children should be supervised to ensure that they do not play with the product.

Do not touch the Lid Vent or bring your hands near the Gas Vent during heating.

- *Steam may result in scalds if the contained water is hot.*

Do not cover or block the Lid and/or Lid Vent with anything such as a dishcloth.

- *Blockage can cause excessive internal pressure which may damage the unit and void the warranty.*

Do not fill over the maximum Water Level Line.

- *Overfilling may cause water to spill out, resulting in scalds if the contained water is hot.*

Do not let the unit fall over. Do not lift, tilt, or shake the unit or carry it by the lid.

- *Doing so may result in scalds by hot water spilling out from the Lid or Lid Vent.*

Close the Upper Lid securely.

- *Water may spill out when the product is overturned, resulting in scalds if the contained water is hot.*

Do not slam the Upper Lid when closing.

- *Water may spill out, resulting in scalds if the contained water is hot.*

Avoid rough handling, dropping or bumping the product.

- *Doing so may cause damage or cease operation of the product.*

Do not use the product near a heat source or on top of induction heating cookers.

- *Doing so may cause fire, breakdown or damage of the product.*

Do not allow water to come into contact with the Control Panel.

- *Doing so may cause product malfunction.*

Allow the product to dry completely when storing the product in areas where it may freeze for a period of time.

- *If water left inside freezes, it may cause breakdown or malfunction.*

Do not drag the product over any surface while attempting to move it.

- *Doing so may cause damage to surfaces such as countertops.*

Avoid using the product near radios, TVs, computers, etc.

- *The product may cause interference with certain electronics.*

Must keep the product and/or the Lid Vent away from fire or any source of ignition.

- *Do not use any open flame or other ignition source within 25cm (10 inches) of the Upper Lid or Lid Vent.*

Pour only potable drinking water into the product.

- *Poor water quality may have negative effects on your health and the product. For hard water, please look for pre-treatment solutions.*

The product should be located on a flat, level surface for operation.

If the Power Cord is damaged, it must be replaced by an appropriate cord or assembly made available by the manufacturer or its service agent.

This product is shelf life sensitive. Do not store for more than 6 months prior to installation and operation.

2 MAIN FEATURES

The Biolux EOS7150 Series (EOS7150-H & EOS7150-HG) Hydrogen Water Pot has been developed to produce hydrogen enriched drinking water.

The of EOS7150-HG model provides a source of high purity hydrogen gas for inhalation.

Other features include:

Safety



Automatic Shut-Off



Smart Heating

Convenience



1.8L Portable



Soothing Lighting



Drinking & Inhaling

Intelligence



**Keep Concentration
at Peak Levels**



**Informative User
Interaction**

The product produces pure hydrogen (and oxygen as a by-product) by the electrolysis of water using a Proton Exchange Membrane (PEM) cell. Only pure or deionized water (Reverse Osmosis Water) is the only liquid that will come into contact with the cell. As this is consumed it must be refilled from time to time as required.

To ensure the product meets our high expectations with regards to reliability and performance, we have tested this model extensively at our manufacturing plant to ensure reliability and longevity of the unit.

3 SPECIFICATIONS

SPECIFICATIONS		HYDROGEN WATER POT	
Model No		EOS7150-H	EOS7150-HG
Features		Heating function up to 80°C (176°F)	
		Hydrogen Enriched Water	Hydrogen Enriched Water Hydrogen Gas
Capacity		1.8 L	
Voltage		AC 100 - 120V, 50/60Hz or AC 220 - 240V, 50/60Hz	
Rated Power		200W	
Hydrogen Production Purity		> 99.999%	
Hydrogen Water	Concentration	1.0 - 1.2 ppm*	
	ORP	-550 mv (approx.)*	
	pH	No change to water pH	
Heating Temperatures		50°C - 65°C - 80°C (122°F - 149°F - 176°F)	
Hydrogen Gas	Delivery Rate	NA	> 12 ml/min
External Dimensions (W x D x H)		185 x 290 x 330 (mm)	
Net Weight		3 kg (approx.)	
Safety Qualifications		No by-products (Hypochlorous Acid & Ozone)	

*Dissolved concentrations of hydrogen in water and ORP may vary according to water quality and temperature.

4 PARTS & HANDLING INSTRUCTIONS

Part Discriptions

Filter Chamber

- Install Filter and pour RO water for electrolysis in here.

Cannula Connector (Accessory, EOS7150-HG exclusive)

- Used for cannula connection to the Lid Vent in Model EOS7150-HG. For use instructions, see pg.19.

Lid Opening Lever

(EOS7150-HG exclusive) **Lid Vent**

- Do not block this Vent.
- Connect Cannula Connector here for inhalation use.

Filter Lever

Filter Cartridge

- For care and use instructions, see pg.24.

- The exhaust contains hydrogen gas. Do not use an open flame or other ignition sources within 25cm (10 inches) of the Lid Vent. This could pose a fire hazard.

Inner Lid Gasket

- Provide sealing to maintain pressure for hydrogen dissolution.
- Prevent water leak when tilted.

Lid Latch

Pure Water Chamber

- Collect pure water for electrolysis in here.
- Vent oxygen here.

Inner Container

- Borosilicate Hard Glass

Control Panel

Spout

- Dispense Hydrogen Water from here.
- Remove the cap before use.

Maximum Water Level

Water Level Window

Drip Grid

Power Cord

- The shape of plug differs according to region.

Drip Tray

Twist Tie

- Remove the twist tie holding the Power Cord before use.

Drain Tube

- For use instructions, see pg.19.

Heating Surface

Cleaning Powder (Accessory)

- Citric Acid 40g. For use instructions, see pg.25.

LED Light

Hydrogen Output

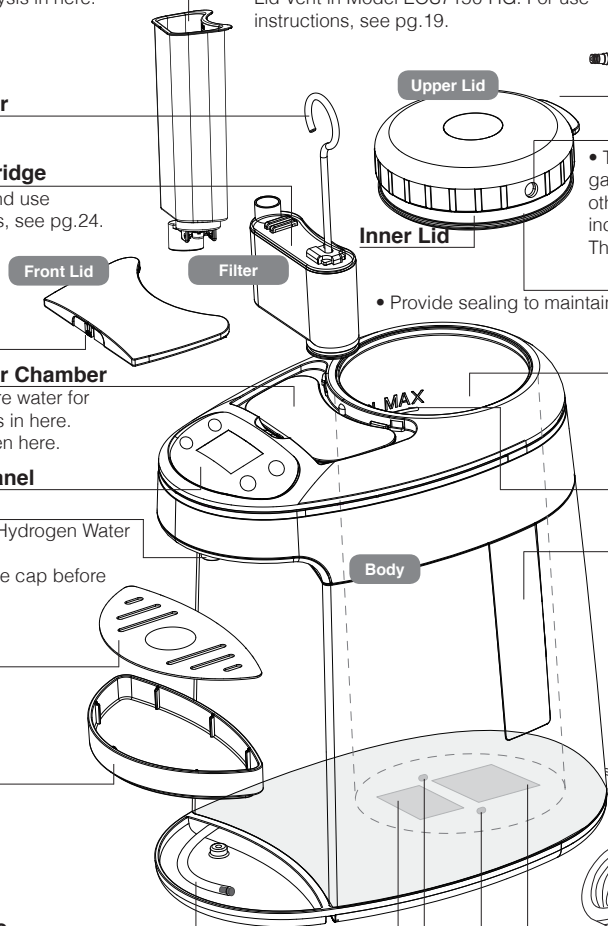

Control Panel

A LIGHT TOUCH is all that is required when pressing buttons

■ EOS7150-H

DISPLAY

- Displays operating information and explanatory texts.

START light

HEATING light

TEMP SET button

- Start Heating Function (see pg.15).
- Also used for Temperature Settings (see pg.16).

START button

- Start Hydrogen Water Production (see pg.15).
- Also used for Resuming Peak Production After Refilling New Water (see pg.14).

DISPENSE light

MENU light

MENU button

- Press to perform Menu Functions (see pg.22).

DISPENSE button

- Press once to Unlock, then press again to dispense water (see pg.18).

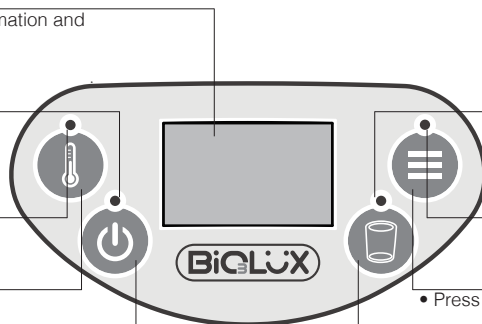

■ EOS7150-HG

GAS DELIVERY & MENU light

GAS DELIVERY & MENU button (dual-functions in EOS7150-HG)

- Start Hydrogen Gas Timer (see pg.20).
- Also used to perform Menu Functions (see pg.22).

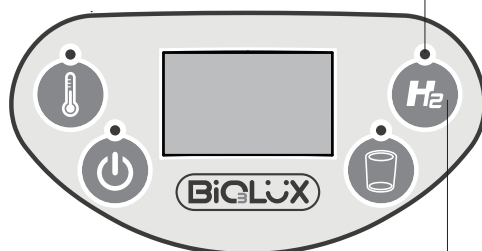

In EOS7150-HG



5 PREPARATION BEFORE USING

How to Detach / Attach the Front Lid

- **To Detach**
- 1 Lift the Front Lid to about a 15-degree angle.
 - 2 Pull the Front Lid forward to remove.

- **To Attach** Push the Front Lid back into place at the same angle until it clicks shut.

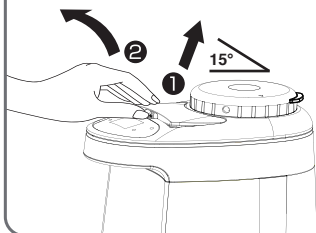

How to Open / Close the Upper Lid

- **To Open**
- 1 Hold the Pot Body down.
 - 2 Lift up the Upper Lid using the lever.

- **To Close** Press lightly on the Upper Lid until it attaches to the Body with no gap.

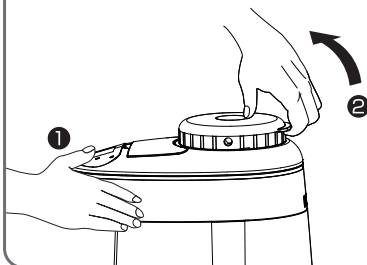

The product needs water to function. Water is filled separately in the Filter Chamber and Inner Container. The quality of the water used for the product will have an impact on the time between cleanings and ultimately on the life of the product.

Water to be Added into the Filter Chamber

**Reverse Osmosis (RO) /
Pure Water Recommended**



Do not use local tap water.

The water added into the Filter Chamber is used exclusively in the electrolysis for hydrogen production, for which, the higher the water purity, the better the sustainability of the performance. Although the Filter inside is to provide purification, it is important to use water with proper purity levels to sustain the performance. Please adhere to the operating guidelines for the water that is to be added into the Filter Chamber.

- Total Dissolved Solid (TDS) - Less than 40ppm
- Conductivity - Less than 80 μ S/cm



Do not use tap water unless you are sure the quality adheres to the above requirements. If the product is operated with poor water quality in the Filter and/or Pure Water Chamber, the warranty will be void.

Local Recommendation

Recommended to use RO water.

Water to be Added into the Inner Container

Filtered and / or Purified Water is Recommended



Do not use local tap water, which is unfiltered.

The water in the Inner Container is for hydrogen enrichment and drinking. The water quality must meet your local drinking water standards. Poor quality water may have negative effects on your health and the product.



Local water conditions may require treatment of water to inhibit scale formation, sediments and to remove chlorine, odor and taste. Please check with your local water treatment services for recommendations. No Warranty on damage as a result of this unit requiring cleaning due to hard or poor water quality.

Do not pour anything other than water into the product.



When using mineral or alkaline ionized water or hard water (> 180ppm CaCO_3):

When mineral water, alkaline ionized water or hard water is used, after heating, a floating residue or a milky white substance may form on the surface of the Inner Container. This is due to the minerals in the water and is harmless to your health. Frequent cleaning is recommended.

To clean the product before using for the first time, please refer to “Cleaning and Maintenance” on pg.24.

Standard Preparation Procedures

- 1 Place the product upright on a flat surface**



The product should be located on a flat, level surface for operation.

- 2 Assemble the Filter Lever onto the Filter Cartridge. Open the Front Lid and attach the Filter Cartridge at the bottom of the Filter Chamber**

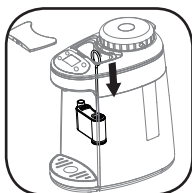

- 3 Remove the Spout cap and plug the product to a standard AC outlet**

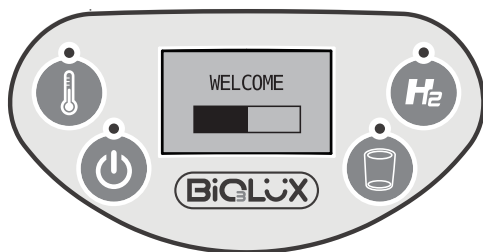
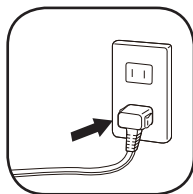
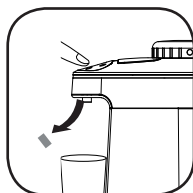

The product takes
10 sec to start up.

- 4 Select language**

Initial Use

Select your language from the menu. Once you have selected your language, the Display will be displayed the selected language at every restart.

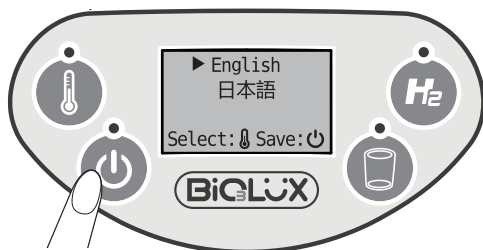

To change the language afterwards, please see pg.23 for further instructions.

5 Fill the Filter Chamber with the appropriate quality of water to the MAX line

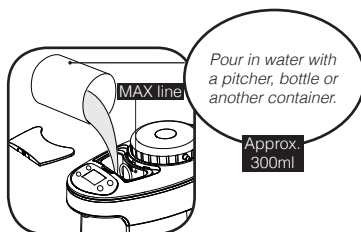
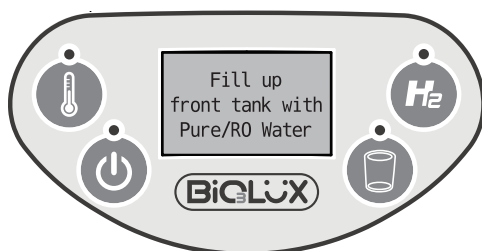

- Please refer to pg.09 for the operating guideline on adding water to the Filter Chamber.
- Do not pour water directly from tap or place the product on a wet surface such as a sink.
- Do not fill above the MAX line.
- Use RO / Pure water only.

6 Open the Upper Lid and fill the Inner Container with quality filtered water to the MAX line

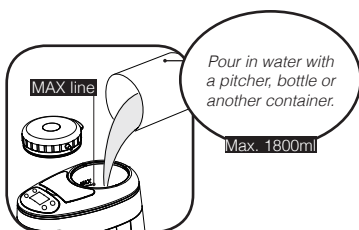

- Please refer to pg.10 for the operating guideline for the water to be added to the Inner Container.
- Do not pour water directly from a tap or place the product on a wet surface such as a sink.
- Do not fill above the MAX line.

7 Standby ready. Ensure Front and Upper Lids are reattached and closed before using.

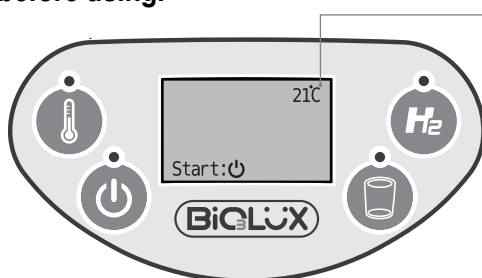

Current water temperature

Upon successful completion of all the above preparations, the product is now ready to deliver hydrogen gas and hydrogen water.

6 HOW TO USE

The first time you use the new product you may notice the smell of plastic. This is normal and will gradually go away.

Be sure to attach the Filter Cartridge, fill the Filter Chamber and Inner Container with the proper required quality of water to the MAX line before proceeding to operate.

A bit less bubbling may be seen at initial use of the product. The bubbling will be increased gradually in 4-8 hours while keeping the use.

Produce Hydrogen Water

Hydrogen Water Production ON

■ Press once on the  button.

During Standby / Heating Function

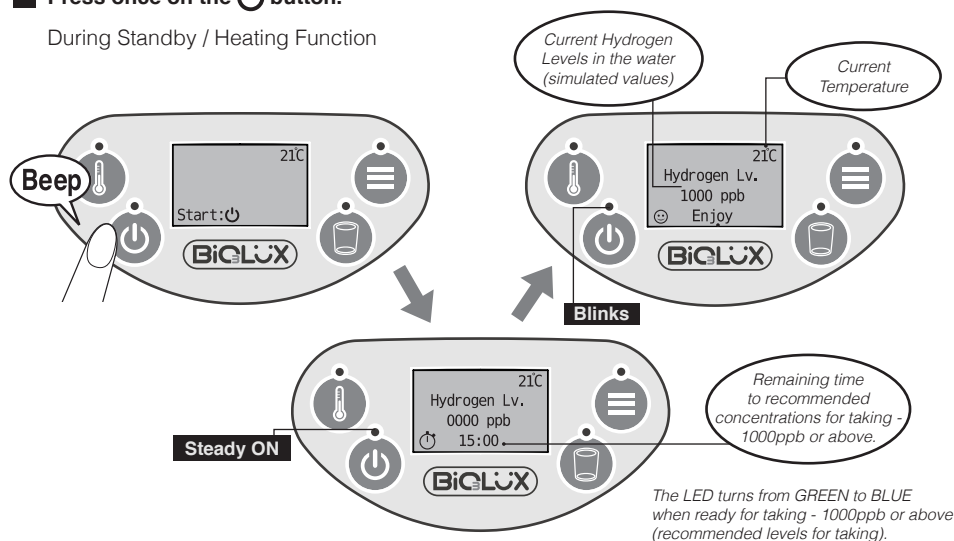

Time vs. Dissolved Hydrogen & ORP Levels

Operation Period	10 Min	15 Min	20 - 30 Min
Dissolved Hydrogen Levels (ppb)	700~800	900~1000 (above)	1100~1200 (above)
ORP Levels	below -400	below -450	below -500
LED Effects	Green	Blue	

* Dissolved concentrations of hydrogen in water and ORP may vary according to water quality and temperature.

* LED Effects can be turned off. For use instructions, see pg.23.

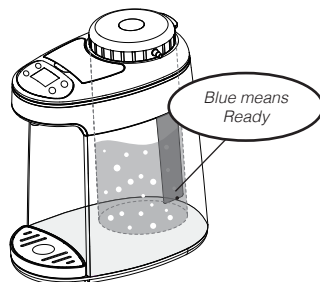

Observed hydrogen bubbling in the Inner Container.
Having some bubbles of uneven sizes at the starting stage is normal.

Automatically Maintaining Peak Concentration

Once the hydrogen water concentration reaches the peak - 1,200ppb, the system will start the "Automatically Maintaining Peak Concentration" mode to maintain this saturated status automatically.

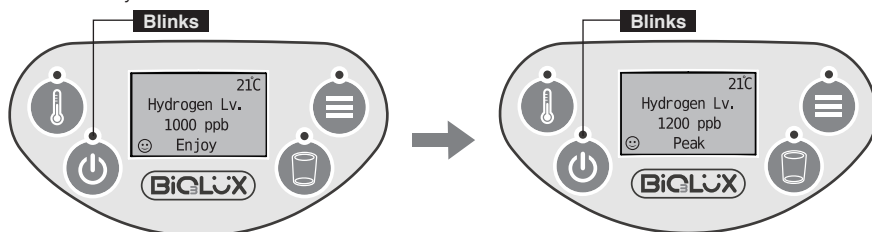

Reduced amount and/or having smaller sizes of bubbles during period of "Automatically Maintaining Peak Concentration" is normal.

The system is programmed to reduce the unnecessary peak production after 30 minutes from the initial start.



Each time the hydrogen water production function is activated, the system will provide 3-hour uninterrupted hydrogen production and concentration maintenance. During this period, if the user does not perform any operations (including start, restart, and water outlet, etc.), the hydrogen production will automatically stop after 3 hours.

-If there is any operation during this period, the system will restart the timer after the operation for a 3-hour period.

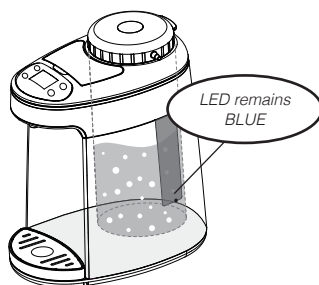

Resuming Peak Production After Refilling New Water

■ Press once on the  button.

Anytime during Hydrogen Water Production after refilling new water into the Inner Container.

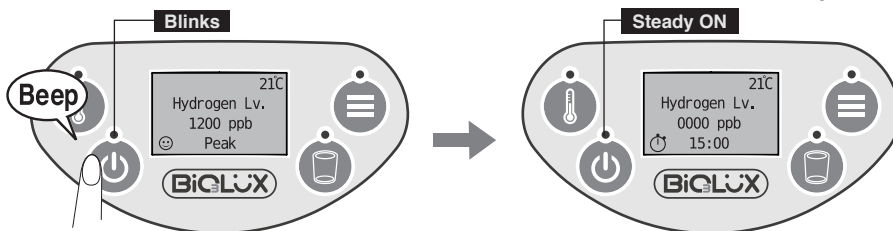
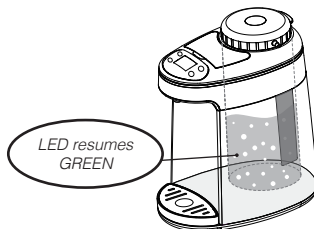

The "Resuming Peak Production" function can become fully automatic while Heating Function is activated (see further instructions on pg. 17)

Hydrogen Water Production OFF

■ Press and hold the  button for 3 seconds.

During Hydrogen Water Production ON / Automatically Maintaining Peak Concentration

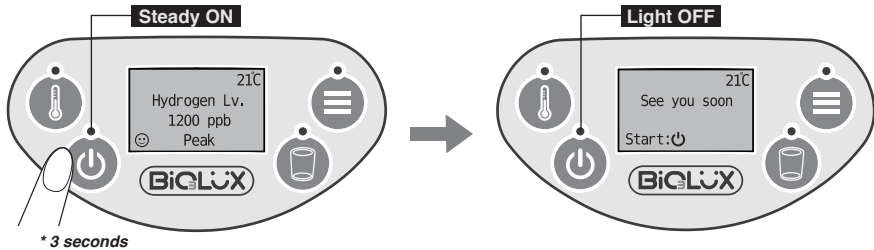

Heating & Maintaining Temperature ON

1 Press once on the  button to unlock.

Either during or not during the operation of hydrogen water production.

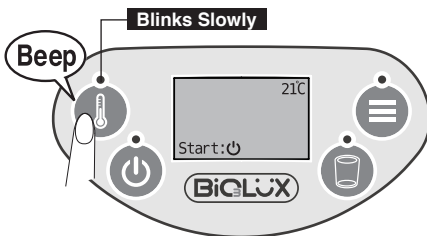

The Heating green light blinks slowly, the function is unlocked for 3 seconds.

Heating Lock

An automatic safety function to avoid unwanted heating if the  button is accidentally pressed.

- If the Heating Function is not triggered, the Heating Lock is activated after 3 seconds.

**Do not activate the Heating Function when the Inner Container is empty.*

Heating & Maintaining Temperature ON

- 2** Press again on the  button to start Heating & Maintaining Temperature based on settings.

During the function unlocked period.

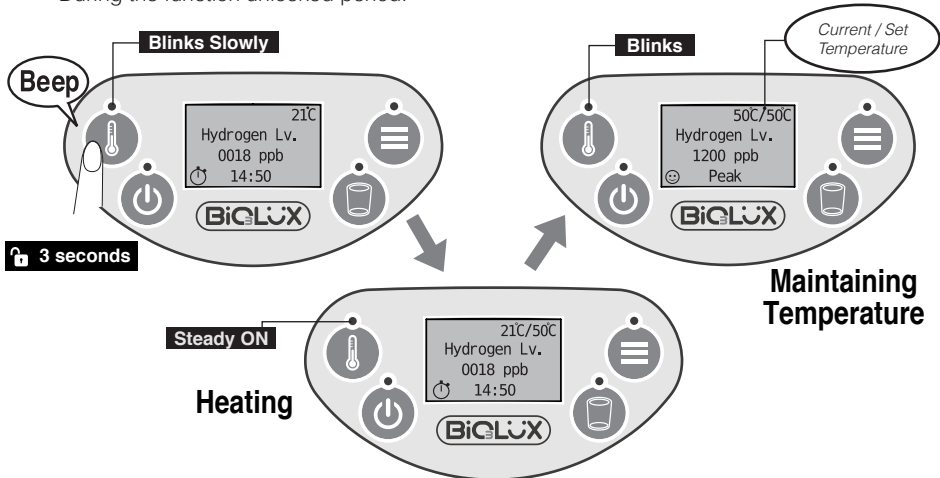

Changing Temperature Settings

- Press the  button twice to change temperature settings (PS. the first press is to unlock the function).

Under Standby or Heating Mode

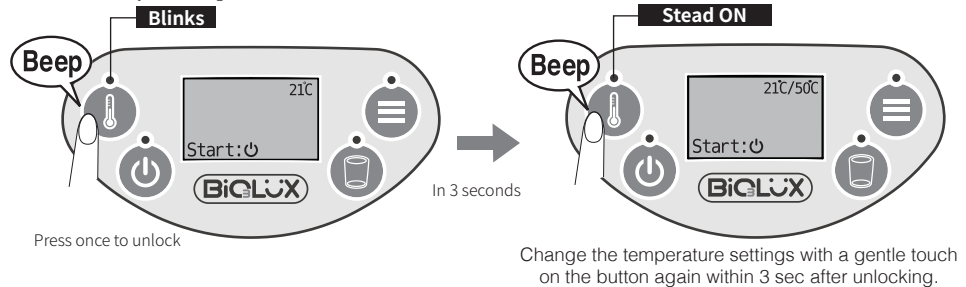

Current Temperature / Set Temperature

21°C / 50°C → 21°C / 65°C → 21°C / 80°C
70°F / 122°F → 70°F / 149°F → 70°F / 176°F

Change the temperature settings with a gentle touch on the button again within 3 sec after unlocking.

Every press on  can change the heating settings as shown in the left.

Stop at the desired temperature option to fix the setting and the pot will start to heat.

3-hour Automatic Heating Stop

Activate the Heating Function provides a 3-hour Heating & Maintaining Temperature based on settings and it will stop automatically.

- To stop Heating at anytime, press the  button again.
- If there is any operation during this period, the system will restart the timer after the operation for a 3-hour period.

Automatically Resuming Peak Production During Heating

- The "Automatically Resuming Peak Production" function is available while Heating Function is activated.

When refilling new water in the Inner Container and there is a detection of 3°C (7°F) reduction during the Heating Function is on, the system will reactivate the Resuming Peak Production automatically. The production time will be rescheduled for a new 15 minutes to re-enrich the hydrogen water concentration to peak.

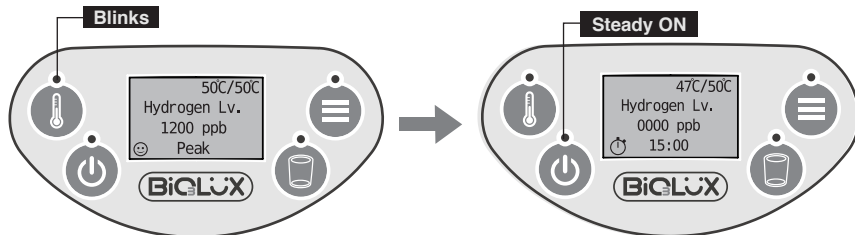

Automatic Overheat Protection

- When system is overheating (water is empty when heating), a safety protection will be triggered to suspend all functions until system cools.

How to do:

Unplug the pot and wait till the temperature to cool before re-plug.

Note:

Frequent overheat may cause deformation to the product.

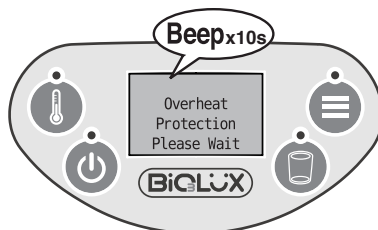

Heating & Maintaining Temperature OFF

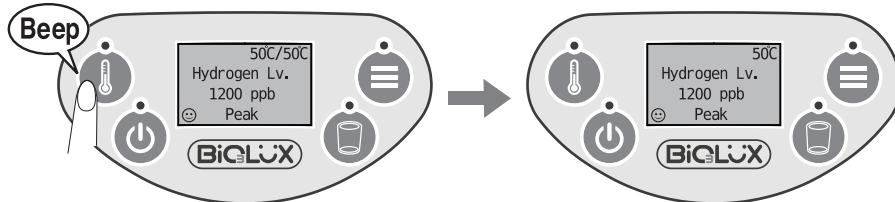

In the case where the Heating & Maintaining Temperature function is ON during the hydrogen water production, deactivating the hydrogen water production will also turn off the Heating & Maintaining Temperature function.

Dispensing Hydrogen Water

1 Press the button to unlock

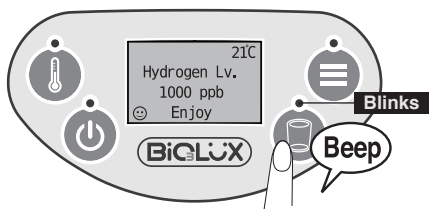

The DISPENSE green light blinks, the function is unlocked and water can be dispensed now.

- When the DISPENSE light is off, water cannot be dispensed.

2 Press the button again to dispense water

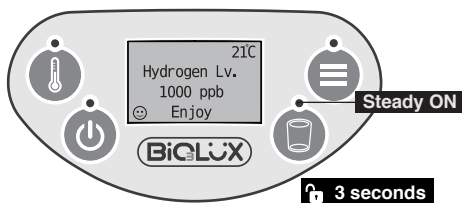

Activate dispensing with a gentle touch on the  button again within 3 sec after Unlocking. The "DISPENSE" green light remains "on" during water dispensing.

Automatic Dispense Stop

Press once the  button provides a 10-second dispensing and it will stop automatically. [Approx. 250ml (±10%)]

- To stop dispensing within 10 seconds, press the  button again.

**Right after dispensing, the DISPENSE light turns off and the Dispense Lock is activated.*

Dispense Lock

An automatic safety function to prevent water from dispensing if the  button is accidentally pressed.

- If no water is dispensed, the Dispense Lock is activated after 3 seconds.

**Do not tilt or shake the product after dispensing. Water may drip from the Spout, causing scalds if the water is hot.*

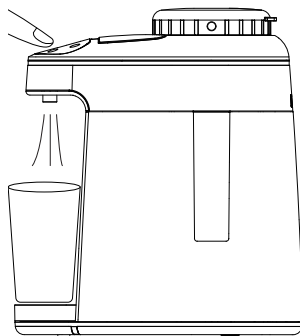

How to Dispose Water

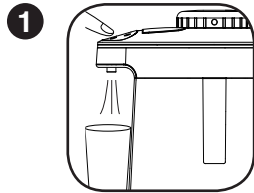

Dispense as much water out as possible

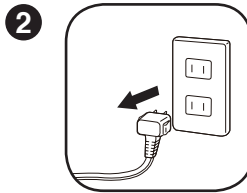

Unplug the Power Cord

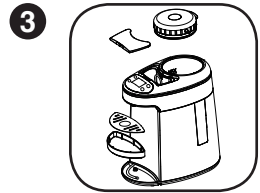

Detach the Front and Upper Lid and remove the Drip Grid and Tray

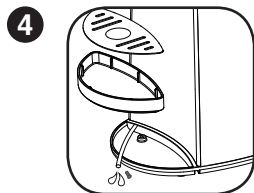

Remove the Drain Tube Cap and drain all the electrolysis water out

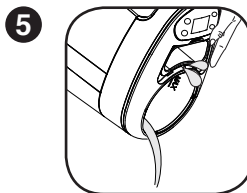

Hold the product with both hands and dispose all remaining water

• There could still be a little water remaining in the Pure Water Chamber after draining through the Drain Tube.

• Take precaution to avoid scalds If water in the Inner Container is still hot. It is recommended to dispose water after it cools.

How to Connect Cannula

* EOS7150-HG exclusive

Connect Cannula to Lid Vent

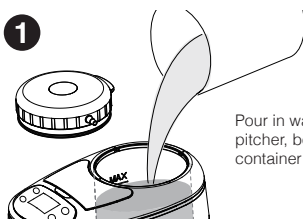

Pour in water with a pitcher, bottle or another container to the MAX line.

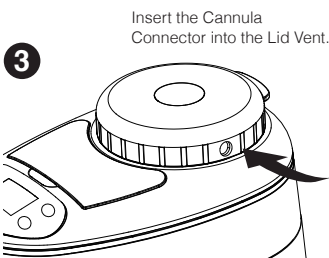

Insert the Cannula Connector into the Lid Vent.

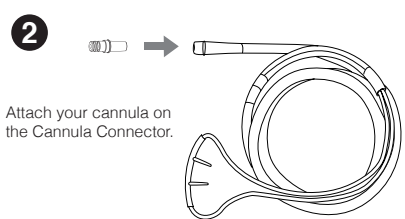
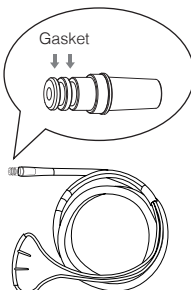

Attach your cannula on the Cannula Connector.



Enjoy hydrogen inhalation!

Gas Delivery Timer Settings

- Press the **H₂** button to change and activate the Gas Delivery Timer settings.

Under Hydrogen Water Production

Default

30:00

60:00

Timer OFF

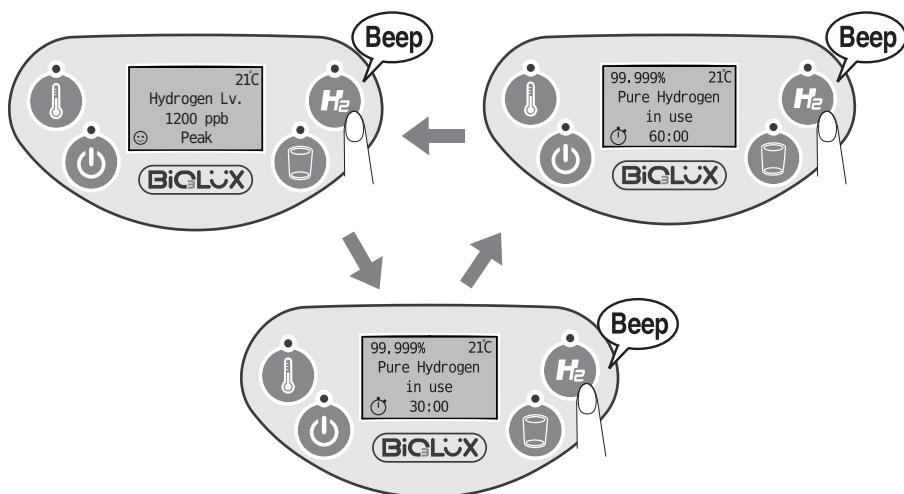

Gas Delivery Timer OFF

- Automatic OFF based on timer settings, or Press once on the **H₂** button to stop the function.

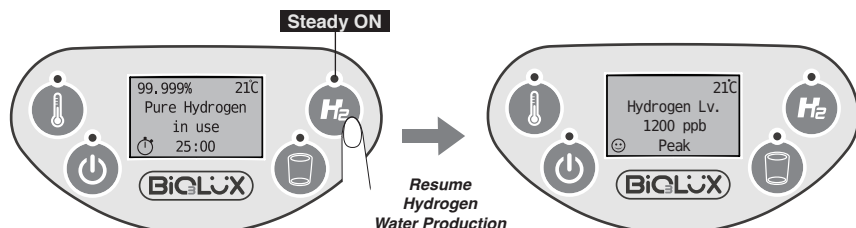

Gas Delivery Timer In Use

■ Press on the **H₂** button to start the Gas Delivery Timer.

Under Hydrogen Water Production

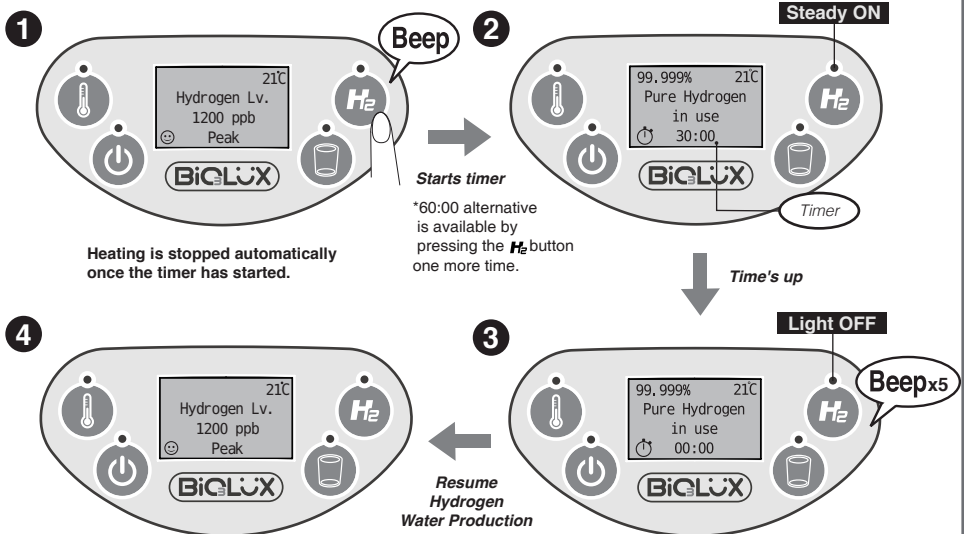

Service Notification

When Service or Maintenance Is Required

■ When is shown

It indicates consumable part(s) replacement is due, including:

1. Filter Cartridge is due and the replacement is required.
2. Hydrogen Cell is due or damaged and the replacement is required.

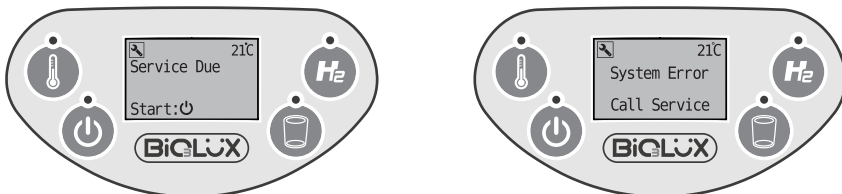

When the above information is noted, please refer to page 23 to proceed to status checking. Also, please contact your customer service agent to arrange a service for the product.

7 SYSTEM MENU & SETTINGS

Enter System Menu

- Press and Hold on the  button for 3 seconds to enter system setting menu.

Under Standby

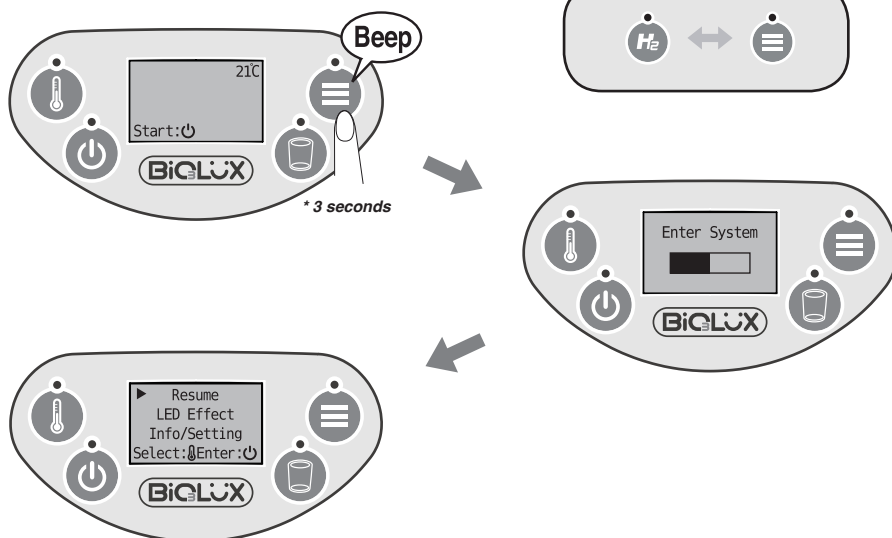

Select Resume to return the standby mode.
Select LED Effect to turn on/off the lighting effects.
Select Info/Setting to enter system information and replacement reset.

LED Effect ON/OFF

- Select **LED Effect** to turn ON and OFF the lighting effects.

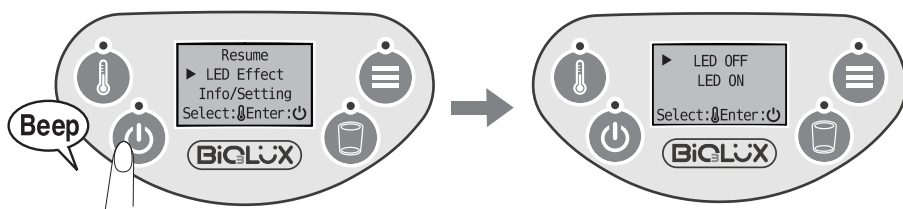

Resume to Standby once completed.

Info/Setting

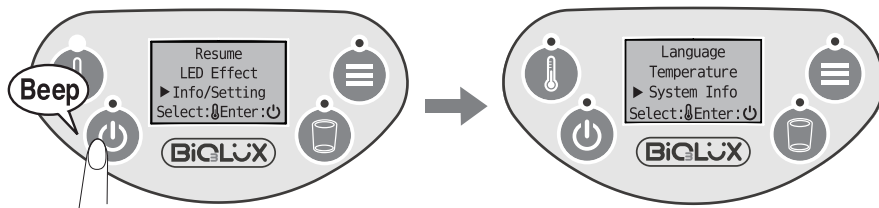

- 1** Select **Language** to change System Language settings



- 2** Select **Temperature** to change Temperature unit settings

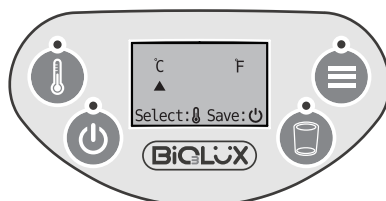

- 3** Select **System Info** to check the working status, part's remaining life and to reset the life after replacement.

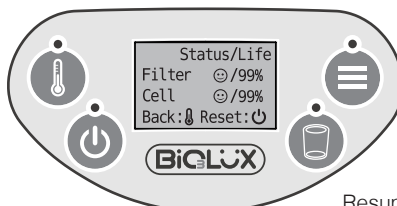

😊 In good condition.

🔧 Service due (remaining life less than 2% or has finished, or a failure has been detected)

Resume to Standby once completed

Explanation of other possible status

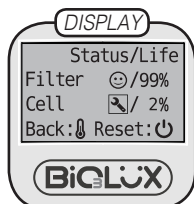

Filter life end.
Replace as needed.

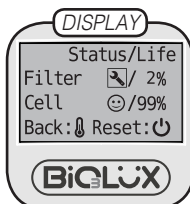

Hydrogen Cell life end.
Replace as needed.

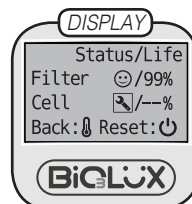

Hydrogen Cell malfunction.
Replace as needed.

- 4** After completing part replacement, please select System Info again and press [Down] button to enter reset options. System will resume to standby after the reset is completed.

8 CLEANING & MAINTENANCE

Always unplug the Power Cord. Remove the Filter, detach the Drip Grip and Tray, dispose all water, and allow to cool completely before cleaning



- Do not use a thinner, benzene, abrasive cleansers or brushes (nylon or metal) detergents, alkaline soaps, bleach or anything that may damage the surface of the product.
- Do not attempt to dry the product by turning it upside down when the bottom is wet
- Do not use a dishwasher or dish dryer for cleaning or drying.

Pure Water Chamber, Filter Chamber & Filter Cartridge

- **Remove the Filter Chamber and clean the Pure Water Chamber, Filter Chamber and Filter using RO / Pure Water with a soft brush.**

Pull up to remove, press down firmly to attach.

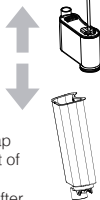

- Must use RO or Pure Water! Do not wash with tap water (will introduce impurities into the core part of the electrolytic cell).
- Be sure to drain out water from the Drain Tube after cleaning (avoid introducing impurities).
- Be sure to reattach the Filter after cleaning. If you find it difficult to clean the Filter, replace it with a new one.

Inner Container

- **[Daily] Wipe with a soft wet sponge.**
- **[Monthly/periodically] Perform Citric Acid Cleaning.**

- Do not use abrasives such as polishing powder, scrub brush, nylon brush wire brush or any brushes with a wire core to avoid unnecessary scratches.
- Perform the Citric Acid Cleaning especially when:
 - Milky-white sediments are found on the surface (calcium scaling)
 - White or glittering floating materials are found in the water (crystals or minerals)
 - Slimy residues are found on the surface or in the water (biofilm)
 - Water has an odor (biofilm)

The condition of the Inner Container may vary depending on the water quality and frequency of use.

See pg.25 for how to perform Citric Acid Cleaning

Front Lid, Upper Lid & Body

- **Wipe clean with a damp, well-wrung cloth.**

- Do not wet or soak the Body in water.
- Do not wash any part of the Body or Control Panel with water.

Inner Lid

- **Wipe with a soft wet sponge.**

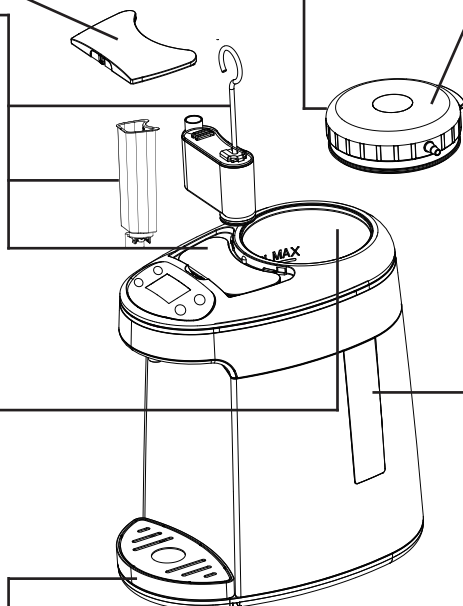

Drip Grid & Drip Tray

- **Wipe clean with a damp, well-wrung cloth.**

Power Cord & Plug

- **Wipe clean with a dry cloth.**

Before storing the unit

- Remove the Filter Cartridge.
- Empty the Inner Container.
- Drain out water from the Drain Tube.
- Dry it completely.
- Pack in a plastic bag and seal the bag.

How to Replace the Inner Lid Gasket

The Inner Lid Gasket may need to be replaced due to wear and tear. Check it once a year.

When the Inner Lid Gasket turns hard and white (the original color is a semitransparent), cracks or tears, loses its pliancy, or for any reasons which allow water (or steam) to escape from the gap between the Upper Lid and the Body



Purchase and replace with a new one
(must be a manufacturer-approved replacement part)

Pry out and pull off the old Inner Lid Gasket from the outer circumference. Then, fit the new Inner Lid Gasket securely to the same position as shown in the figure.

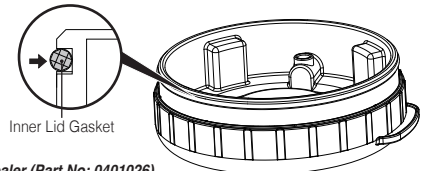

The Inner Lid Gasket replacement part is available from an authorized dealer (Part No: 0401026)

How to Clean with Citric Acid



- Perform every 1-3 month(s) of usage.
- Do not drink the water used for citric acid cleaning.
- Only used for the Inner Container (NOT FOR THE PURE WATER CHAMBER).

- 1 Plug the product, ensure the product is ready and the Filter Chamber is filled with RO water (see pg.09).
- 2 Put 20g of the Citric Acid Cleaner (P/N: C71502017-013) in a cup and add warm water to dissolve first. Pour it into the Inner Container and fill with clean water to the MAX line.
** Do not fill over the MAX line.*
- 3 Close the Upper Lid, then press "START" button for 10 seconds to activate the Cleaning function.

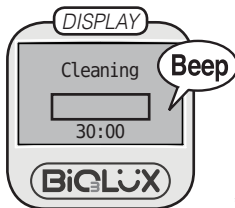

** The cleaning time is 30 min.*



- 4 Dispense the water to clean the water dispenser. Refill clean water in the Inner Container to the MAX line and repeat the dispense operation as many times as needed until the smell of the citric acid is removed thoroughly.
** Repeated citric acid cleaning may be necessary for hard-to-remove residues or if water does not dispense smoothly.*
** Take precaution when disposing remaining water from the Inner Container. Be sure to unplug the unit, remove the Drip Grid and Drip Tray, and drain all the water out of the the Drain Tube beforehand.*

The citric acid is available from an authorized dealer (Part No: C71502017-013)

Replacement Parts

- Consumable parts are available from your authorized distributor/dealer.
- When replacing parts, please check the model number and the parts name beforehand.

Parts Name	Replacement Cycle (approx.)	Part No.
Inner Lid Gasket	12 months	0401026
Filter Cartridge	6 - 12 months ^{#1}	C71502017-011
Hydrogen Cell	24 - 36 months ^{#2}	C71502017-012

^{#1} Depends on the quality of water that is added to the Pure Water Chamber.

^{#2} Depends on the frequency of usage and water quality.

9 TROUBLESHOOTING

Please check the following possible causes and/or solutions before calling for service.

	If...	Possible Cause	Solution
Start-up	No Display	No power or the Power Plug is not connected.	Check the mains, plug and voltage. Connect the Power Plug.
		Water damage.	Call customer service for repair.
		Electronic failure.	Call customer service for repair.
	Display keeps showing "Fill up front tank with Pure/RO water" message	Electrolysis water is empty.	Fill up the Filter Chamber with Pure/RO water.
		Floater got stuck.	Remove the Filter Chamber and adjust the floater at the bottom of Pure Water Chamber.
		Electronic failure.	Call customer service for repair.
Heating & Maintaining Temperature	Water is not hot	3-hour Automatic Heating Stop.	Restart the function.
		Is the Heating Function mode selected?	Press the "Heating" Button (see pg.16).
		Is the Heating temperature set correctly?	
		Electronic failure.	Call customer service for repair.
	Display shows "Overheat Protection" message	Has boiled or hot water (>90°C/190°F) added into the Inner Container?	Unplug the unit, replace with room temperature water. Reconnect the unit after it cool down.
		Empty Water in the Inner Container.	
		Electronic failure.	Call customer service for repair.

If...	Possible Cause	Solution
Observed no bubbling	▶ No power or the Power Plug is not connected.	Check the mains, plug and voltage. Connect the Power Plug.
	▶ Is the Hydrogen Water Production function activated?	Press (start icon) button to start the function.
	▶ Electronic failure.	Call customer service for repair.
Observed reduced bubbling	▶ Once the hydrogen level reaches 1,200ppb, the "Automatically Maintaining Peak Concentration" function will be turned on automatically. At this point, reduced bubbling is normal.	
Water does not dispense or does not pour smoothly	▶ Power Plug is not connected.	Connect the Power Plug.
	▶ The Dispense Lock is not unlocked.	Press the  button twice (see pg.18).
	▶ The Gas Vent is blocked.	Remedy the blockage.
	▶ Scale built up in the water line.	Perform citric acid cleaning (see pg.25).
Water has an unpleasant odor (or a strong odor of chlorine)	▶ The product is new.	This mild new-plastics odor will disappear after a few use.
	▶ The product has not been used for a long time.	Clean the product (see pg.24) or perform citric acid cleaning as necessary (see pg.25).
	▶ Your drinking water contains too much chlorine.	Improve your drinking water quality.
Some filmy, milky white residues is observed.	▶ The mineral contents in the water is high (mineral water or ionized alkaline water)	It is called "scale" and is harmless to your health. Perform citric acid cleaning regularly (see pg.25).



If...	Possible Cause	Solution
Display shows “Service Due” message	Part(s) due for replacement.	Check “System Info” for indication (see pg.23 for instructions). Replace as indicated or call customer service.
Display shows “System Error” message	Hydrogen Cell malfunction.	Replace the Cell as needed or call customer service for repair.
The Power Cord becomes hot	The Power Cord may become hot while the water is heating. This is not a malfunction.	
Humidity builds in the Water Level Windows	If water is poured from a faucet, water may go inside of the Body and there might be moisture present in the Water Level Windows during use. Stop using the product and allow it to dry as it may cause short circuit or electric shock.	



If the problem cannot be resolved, or if you think something is still wrong with the unit, disconnect the plug, reconnect after 30 seconds and operate it again.

10 Q&A ON PRODUCT USE

Is it okay to use the product for liquids other than water?	Do not fill the product with any liquid other than water. It may cause malfunction.
Does the water need to be changed everyday?	To prevent scale from building up, please change the water at least once a day.
Is it okay to use mineral water?	Yes. However, when mineral water is used, a floating residue may develop or milky white substance may form on the surface of the Inner Container. This is due to the ingredients in the water and is harmless to your health.
Is it okay to use ionized alkaline water?	Yes. However, calcium tends to build up on the surface of the Inner Container with this type of water. Frequent cleaning is therefore recommended.
Is it ok to go out while the product is switched on?	It is safe to use the product unattended as it has an Automatic Shut-Off function (power to the heater and generator will be automatically turned off), which will be activated once the unit is without water.

[illegible]

[illegible]

BiOLUX

Biotek Environmental Science Ltd.

www.besgroups.com

Rev. A202008_EN_BES

